



# 3330 L & N Drive, Unit I

## Office Condo

### PROPERTY BRIEF



**DESCRIPTION:** VERY NICE 2<sup>ND</sup> FLOOR OFFICE CONDO WITH ELEVATOR AND STAIR ACCESS.

**SIZE:** MAIN FLOOR: 1,740 SQ. FT. (+/-)  
UPPER LEVEL: 1,650 SQ. FT. (+/-)

**LOCATION:** SOUTH ON MEM. PKWY., LEFT ON DRAKE AVE., RIGHT ON L & N DRIVE. SUBJECT PROPERTY ¼ MILE ON THE RIGHT.

**LAND SIZE:** APPROX. 1(+/-) ACRE 206' X 170' X 261' X 177' (+/-)

**ZONING:** HI - HEAVY INDISTRY

**SALE PRICE:** \$285,000

**CONTACT:** RUSS RUSSELL, CCIM, SIOR, ALC, CEA ♦ 256-536-7777

**FOR OUR MOST UP TO DATE PROPERTY INFORMATION PLEASE VISIT**  
[www.russrussell.com](http://www.russrussell.com)

This property is subject to prior sale or removal from the market without notice. All information shown in this brochure, while based upon information supplied by the owners and from other sources deemed reliable, is not, in any way, warranted by Russ Russell Commercial Real Estate.



Ranger Russell  
Madison County's *First*  
named Real Estate Drone



Huntsville's First CCIM



Huntsville's Second SIOR



Huntsville's First ALC



Huntsville's First CEA



Ruff Russell  
America's *First and ONLY*  
Real Estate Mascot



## FLOOR PLAN

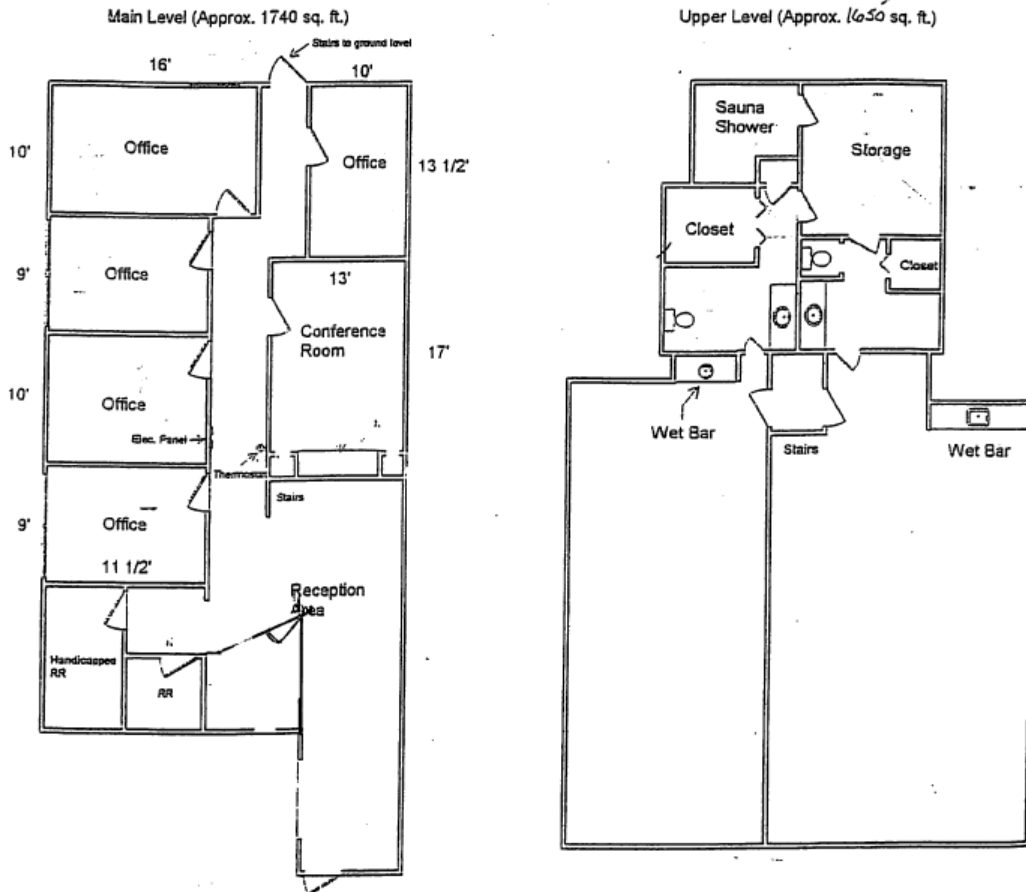

Drawings not to scale